

5200 - SHUTTER CUTTER

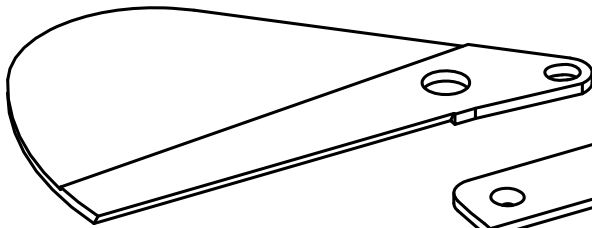

⊙ 5201N  
007-37030-66

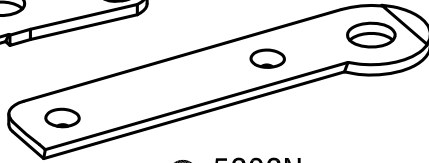

⊙ 5202N  
008-37070-62

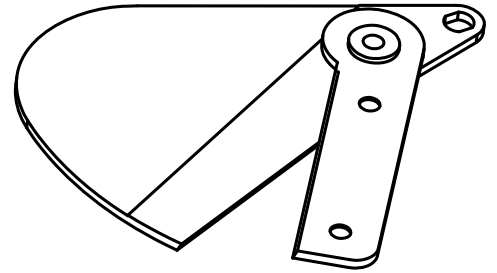

CUTTER ASSEMBLY  
⊙ 5200S-00 (Steel)

5210 - SHUTTER CUTTER ( PIN TYPE )

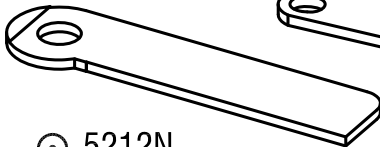

⊙ 5212N  
008-370-5

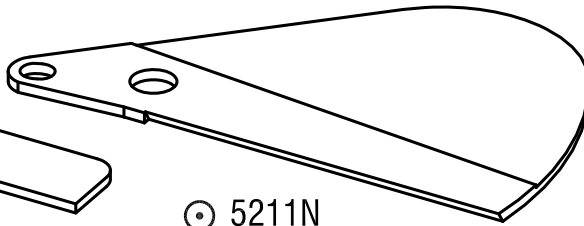

⊙ 5211N  
008-370-6

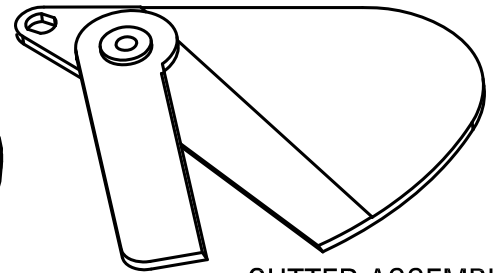

CUTTER ASSEMBLY  
⊙ 5210S-00 (Steel)

5250 - SHUTTER CUTTER ( BUSH TYPE )



⊙ 5252N  
008-370-5  
21G-430-14

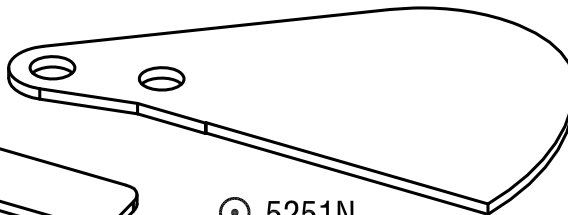

⊙ 5251N  
21G-430-13

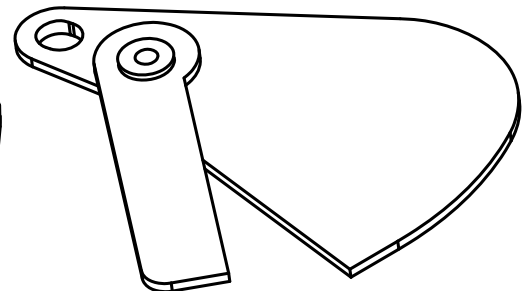

CUTTER ASSEMBLY  
⊙ 5250S-00 (Steel)

5290 - DOFFER SCISSOR 21C/QPRO



○ 5291  
210-401-006



● 5295  
● 5296



● 5295 21C  
● 5296 QPRO



5290-01

MATERIAL CODE : ● SOLID CARBIDE , ○ HSS , ◐ BRAZED CARBIDE , ⊙ TIN COATED