

# FOR CIMMCO KRIPA RAPIER

W40

3550 - ( WEFT )

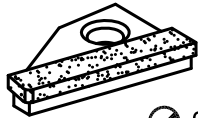

● 3552

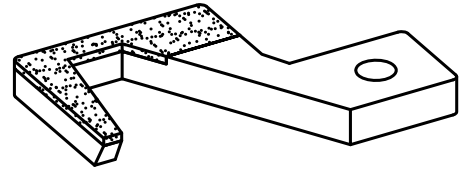

● 3551

# FOR MULLER RAPIER

3560 - MBJ 2 ( WEFT )

3570 - MBJ 3 ( WEFT )

3570 - MBJ 3 ( WEFT )

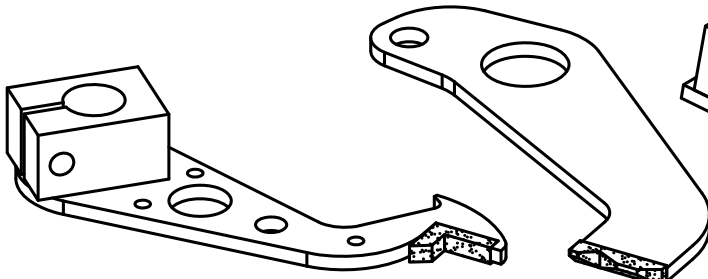

● 3561

● 3562

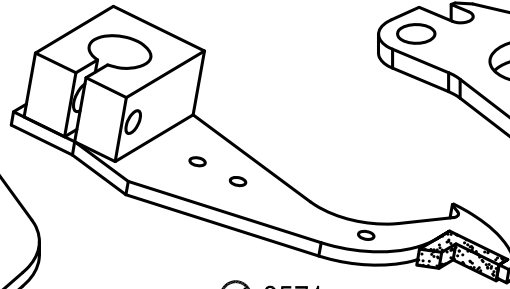

● 3571  
179631846

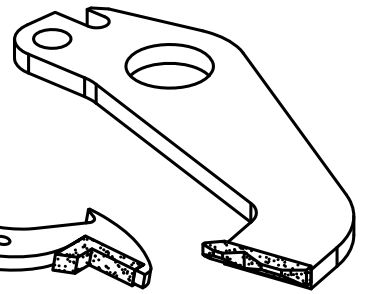

● 3572  
179631629

# FOR HIRAIWA RAPIER

3670 - ELECTRONIC ( WEFT )

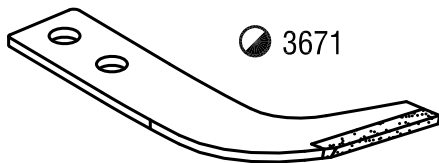

● 3671

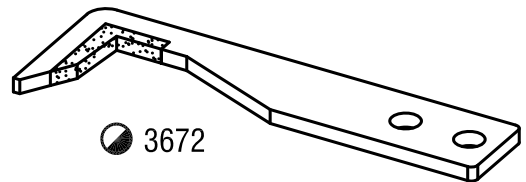

● 3672

3680 - ( SELVEDGE RH & LH )

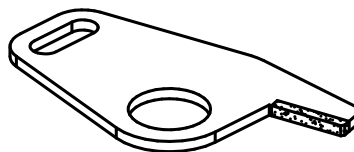

● 3682L  
● (3682R)

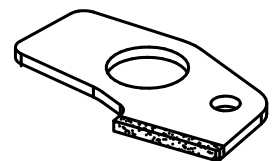

● 3681L  
● (3681R)

3690 - MECHANICAL ( WEFT )

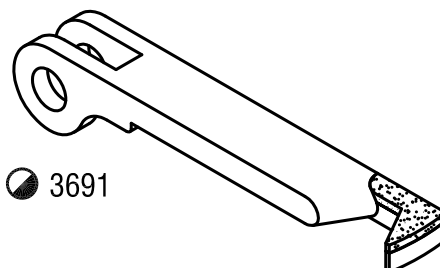

● 3691

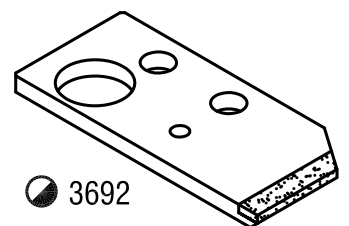

● 3692

MATERIAL CODE : ● SOLID CARBIDE , ○ HSS , ● BRAZED CARBIDE , ⊙ TIN COATED