

# FOR SCHLAFHORST AC5/X5

## SCHLAFHORST 5690 - SPLICER SCISSOR

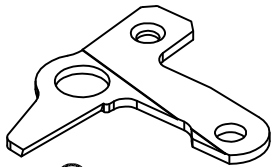

○ 5691  
149-010.699  
148-002.746  
148-006.487

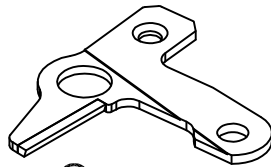

● 5693

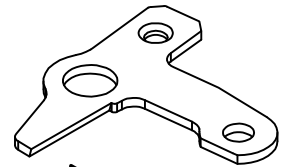

▶ 5697

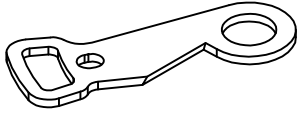

○ 5692  
149-010.711  
149-017.015  
149-006.490

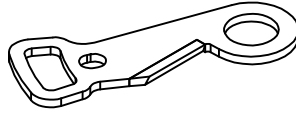

● 5694

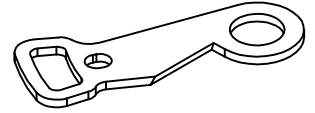

▶ 5698

## SCHLAFHORST 5630 - LOWER SCISSOR

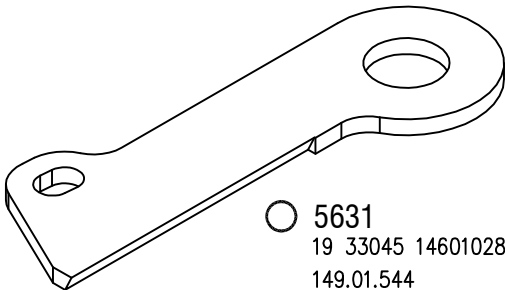

○ 5631  
19 33045 146010280  
149.01.544

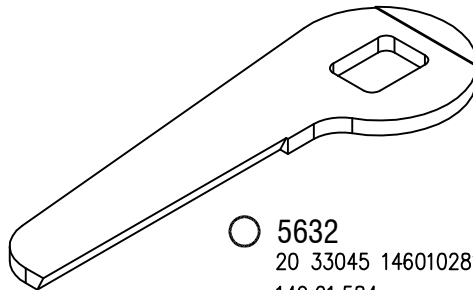

○ 5632  
20 33045 146010281  
149.01.584

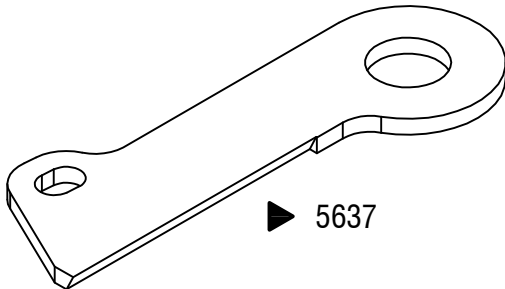

▶ 5637

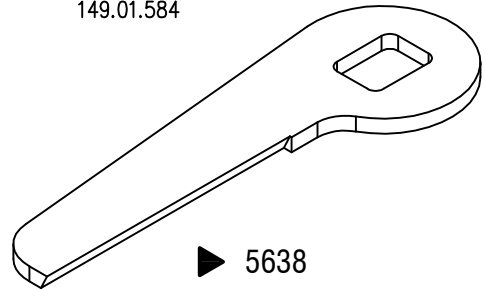

▶ 5638

## SCHLAFHORST 5610 - LOWER SCISSOR

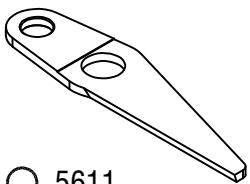

○ 5611  
22 149-013-0866-36111  
149-012.867

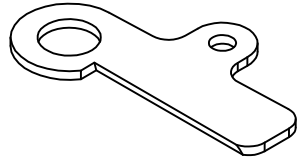

○ 5612  
19 149-014-058-36111  
149-012.997

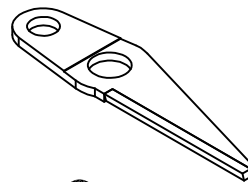

● 5613

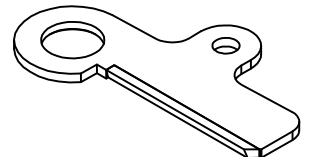

● 5614

## SCHLAFHORST 5650 - LOWER SCISSOR

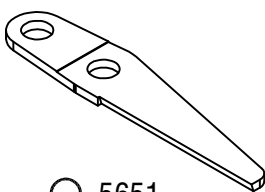

○ 5651

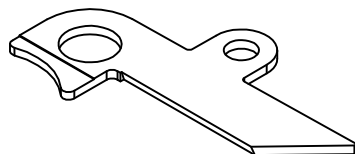

○ 5652

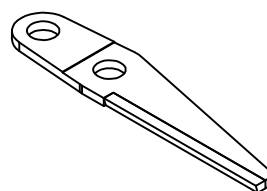

● 5653

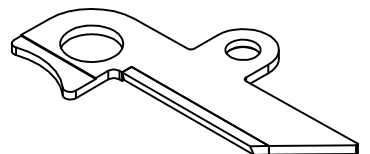

● 5654

MATERIAL CODE : ● SOLID CARBIDE , ○ HSS , ● BRAZED CARBIDE , ▶ ZIRCONIA CERAMIC ○ TIN COATING